

INSTALLATION



PACK CONTENTS



1 x Topside shallow boxed drawer - 83mm

- 1 Drawer runners (L/R)
- 2 Drawer sides and cover caps (L/R)
- 3 Metal back
- 4 Chipboard base
- 5 Internal brackets (L/R)
- 6 Fascia panel (1100mm lengths, cut to required length)*

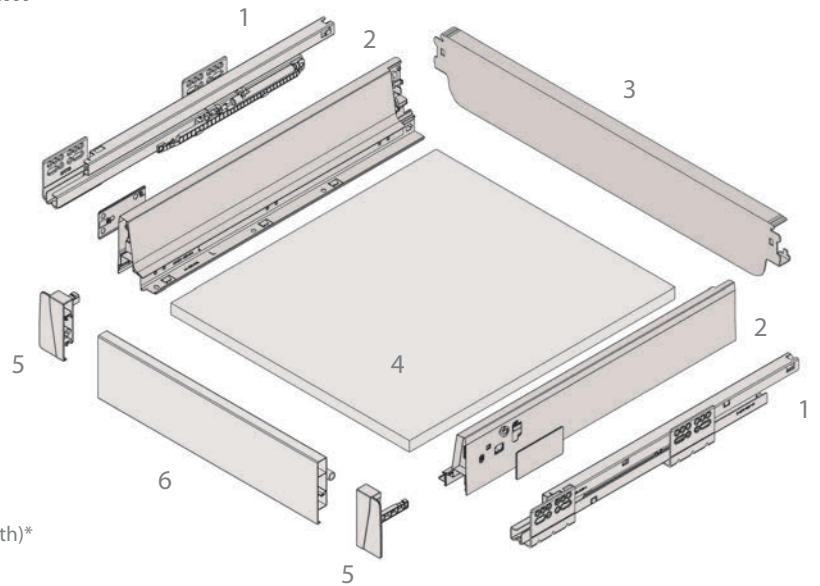

4 x Topside boxed pan drawers - 224mm

- 1 Drawer runners (L/R)
- 2 Drawer sides and cover caps (L/R)
- 3 Metal back
- 4 Chipboard base
- 5 Internal brackets (L/R)
- 6 Glass sides (L/R)
- 7 Front adapters for glass (L/R)
- 8 Rear adapters for glass (L/R)
- 9 Fascia panel (1100mm lengths, cut to required length)*
- 10 Front square rails (1100mm lengths, cut to required length)**
- 11 Side rails (L/R) (Discard any unused rails)

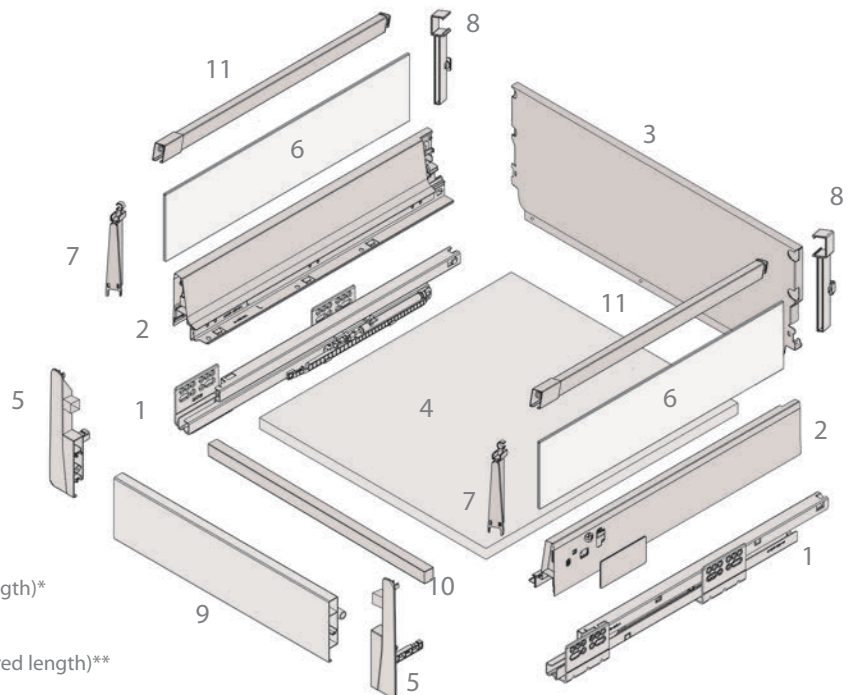

* Fascia panel cutting dimensions: 467mm
(Internal cabinet width - 97mm)

** Front square rail cutting dimensions: 501mm
(Internal cabinet width - 63mm)

NB. You will receive extra parts within your pack. Only the components pictured will be needed to construct your SMARTLARDER. Any extras can either be discarded or kept as spare parts.

PACK CONTENTS



4 x Silence 165 degree soft close hinges
(drilling required on carcass, see [Page 6](#) for dimensions)

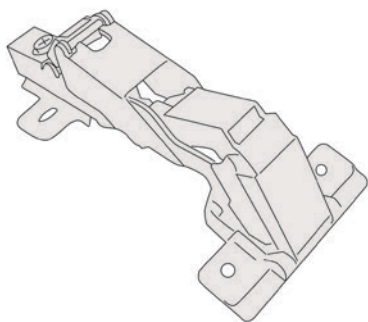

4 x Silence Euro hinge plates 18mm
(drilling required on carcass, see [Page 6](#) for dimensions)

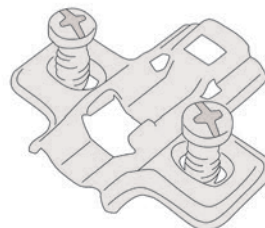

1 x Quickcab Larder Unit, 1970mm high
(only included in the [Complete SMARTLARDER Package](#))

- 1 Top panel
- 2 Fixed shelf
- 3 Bottom panel
- 4 Side panels
- 5 8mm back panel
- 6 150mm adjustable feet

Cam & dowel already pre-inserted with simple screwdriver fixings.

Push panels in position and lock in place with a screwdriver.

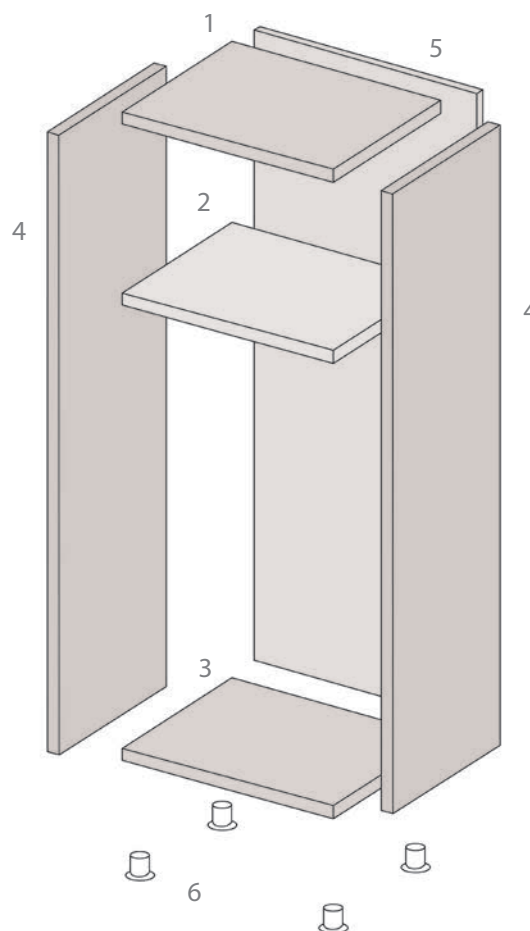

ASSEMBLY



Topside shallow drawer assembly

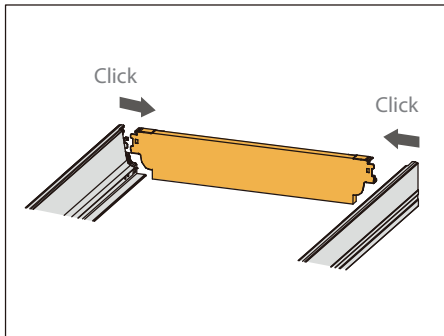

Back assembly

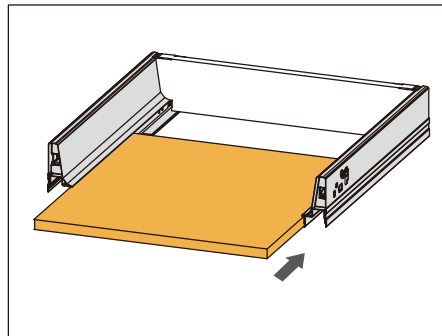

Base assembly

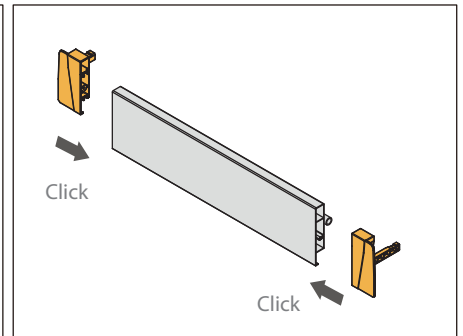

Front assembly

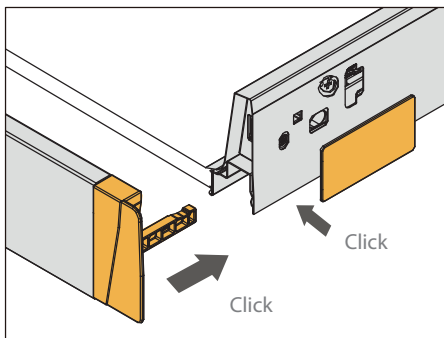

Front assembly (continued)

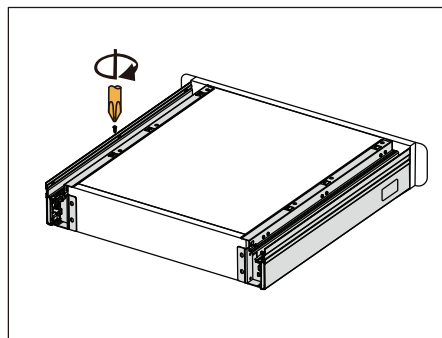

Topside pan drawer assembly

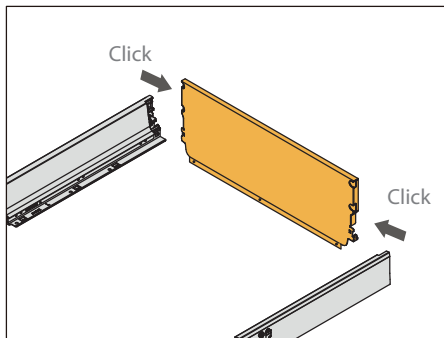

Back assembly

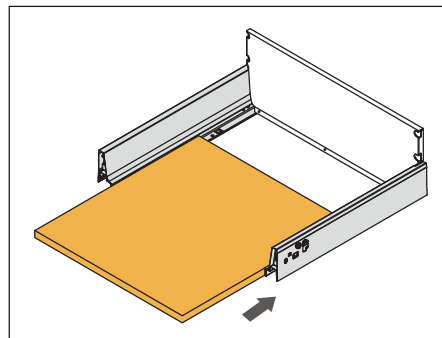

Base assembly

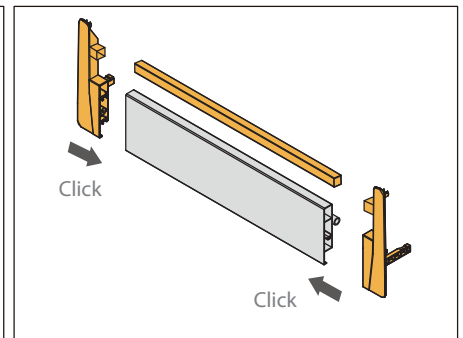

Front assembly

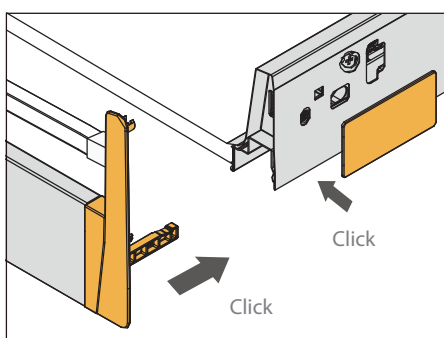

Front assembly (continued)

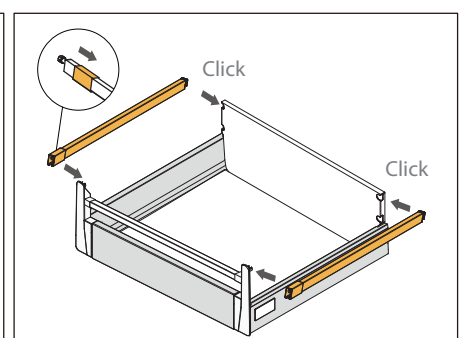
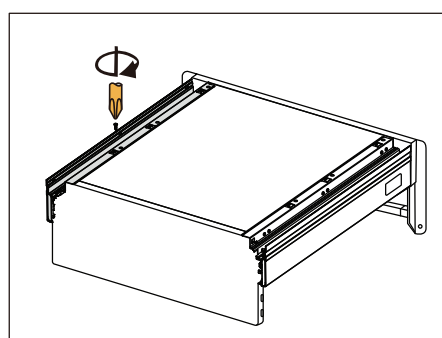

Side rails assembly

ASSEMBLY



Topslide pan drawer assembly (continued)

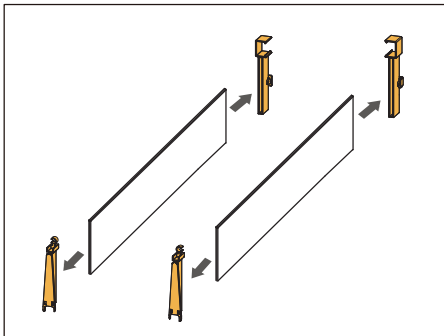

Glass sides assembly

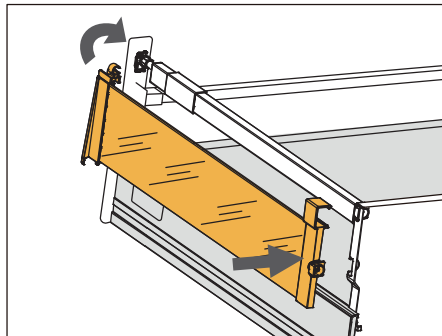

Glass sides assembly (continued)

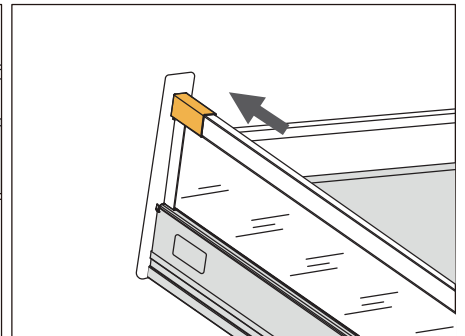

Quickcab Larder Unit assembly

view Quickcab video here:
www.tkc.co.uk/quickcab_video



SAVE 75%
of kitchen cabinet build time*

*Based on 7 1/2 minute standard cabinet build time vs 2 minutes build time for Quickcab.

NB: Quickcab larder unit only included in Complete SMARTLARDER Package

INSTALLATION



All measurements taken from hole centre. Dimensions taken from base, using a 1970mm tall carcass.

Hinge hole positions

Suitable for full height doors or 1245 + 715mm doors. If using 2 doors they MUST be strapped together.

1865mm

pre drilled on TKC carcasses

1350mm

pre drilled on TKC carcasses

640mm

drilling required

280mm

drilling required

Drawer runner positions

350mm

drilling required

350mm

drilling required

350mm

drilling required

350mm

drilling required

43mm

drilling required



Runner positioning

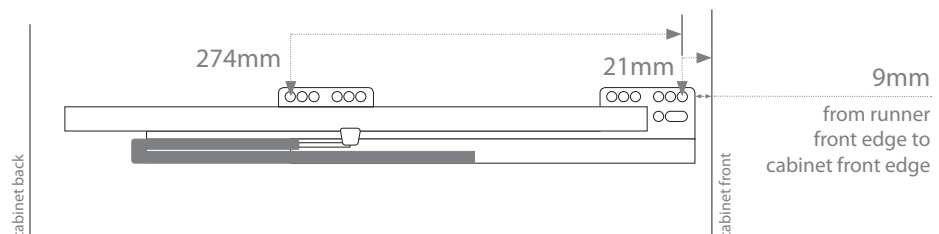

Nb: Please ensure that runners and soft close unit are kept clean and free from dust. When installing units, please cover runners to avoid particles entering the mechanism.



|||||
SMART
LARDER

TKC

Unit 3, Cranberry Drive, Denton, Manchester, M34 3UL
Phone: 0161 336 36 36 | Email: sales@tkc.co.uk | Web: www.tkc.co.uk