



Trade supplier to the
kitchen & bedroom industry

March
2024

Technical and Installation Guide



DECORATIVE SKIRTING PLINTH

Please Note: The information shown in this literature is accurate as at the date of print/release shown on such information but it may be subject to changes after such date. Please therefore ensure that you are viewing the most current product available and check with us if you have any doubt about the suitability of the product or accuracy of the information shown.

DECORATIVE SKIRTING PLINTH PRODUCT OVERVIEW

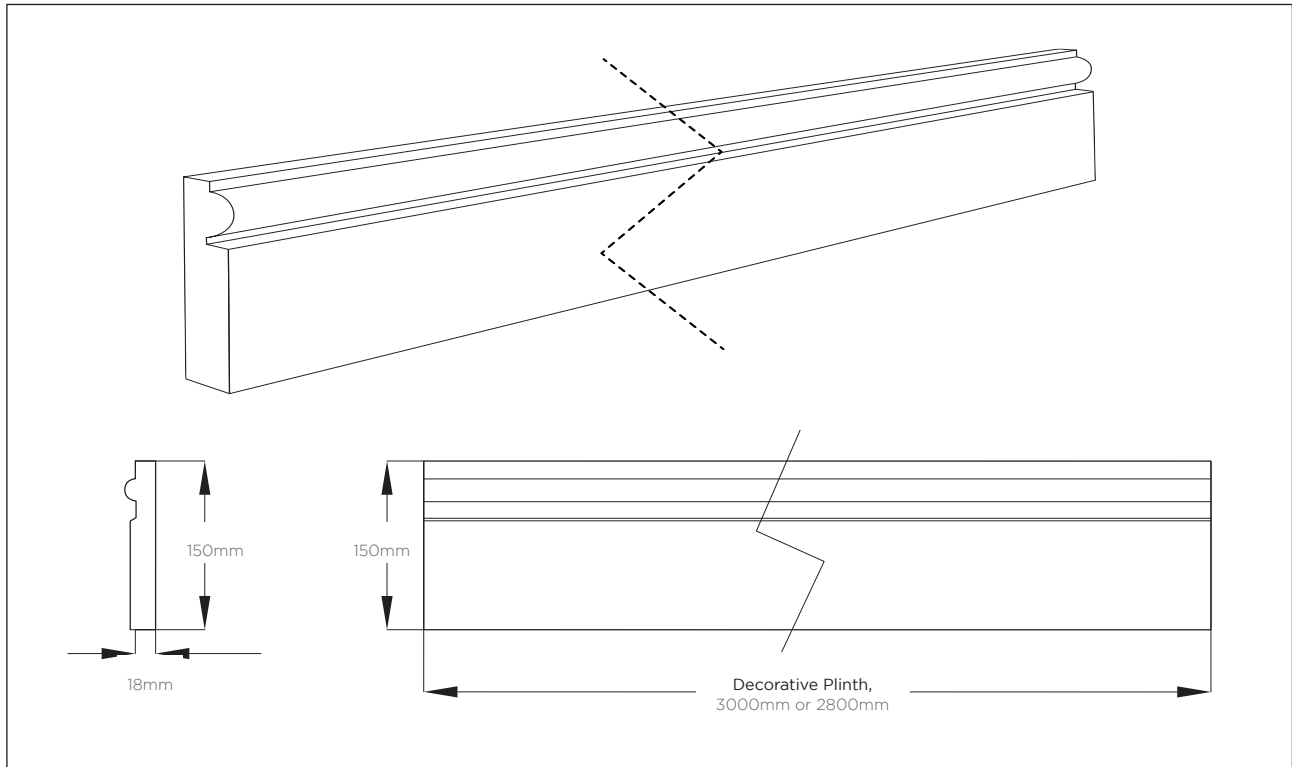

PRODUCT INFORMATION

Product Description:	Decorative Skirting Plinth
Ranges:	Cambridge, Newmarket, Grantham, Windsor / Cartmel, Rydal
Product Colours:	Available in all stocked range colours/paint to order
Product Finish:	Painted Veneer/Foil wrapped woodgrain structure
Base Material:	MDF
Covering Material:	Paint/Foil wrapped
Reverse Colour:	Craft Paper/Unfinished MDF
Product Dimension:	2800/3000mm x 150mm x 18mm

BOXED CONTENTS

Cambridge/Newmarket/Grantham/Windsor

- 1 Finished plinth 2800mm x 150mm x 18mm
- 2 Finished rail with tongue 2800mm x 50mm x 22mm
- 3 Raw MDF rail 2800 x 50mm x 22mm

Cartmel/Rydal

- 1 Finished plinth 3000mm x 150mm x 18mm
- 2 Finished rail with tongue 3000mm x 50mm x 22mm
- 3 Raw Chipboard rail 2800 x 50mm x 22mm

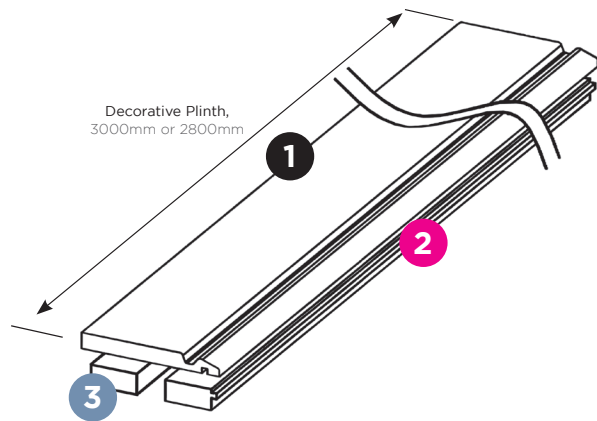

DECORATIVE SKIRTING PLINTH INSTALLATION

Side view showing fixing rail to bottom of cabinet

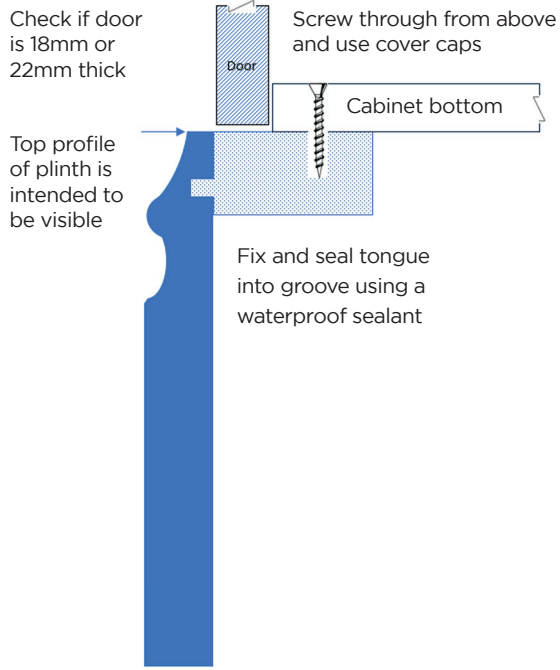

Side view showing plinth wrapping around end panels

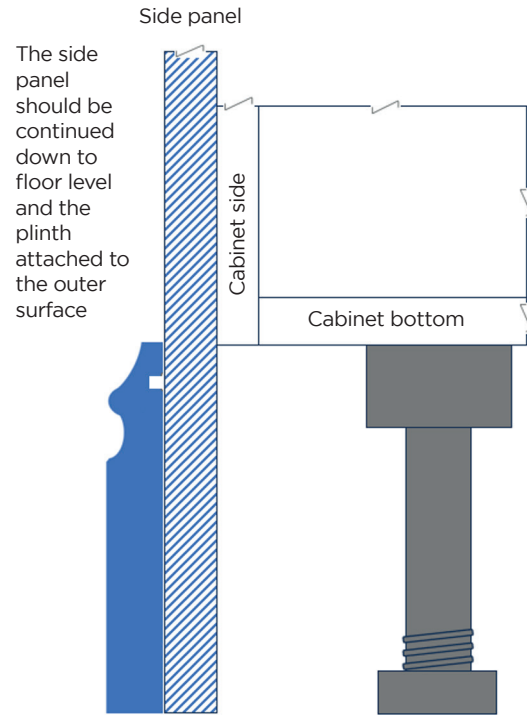

Top view showing position of corner mitre

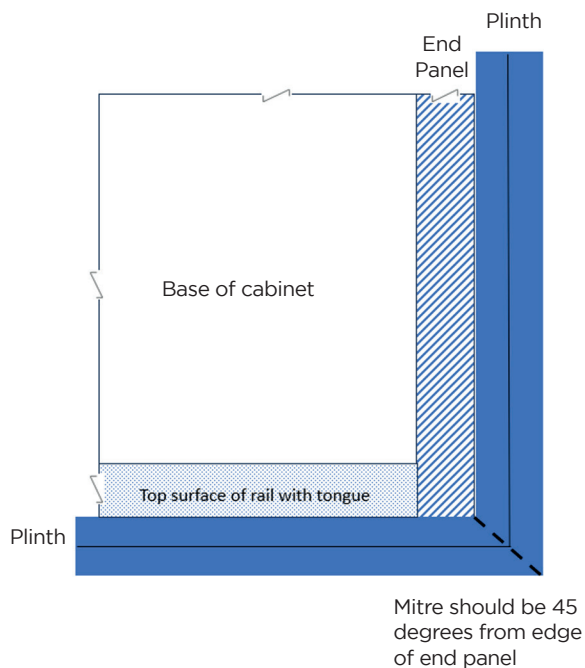

Additional Supports

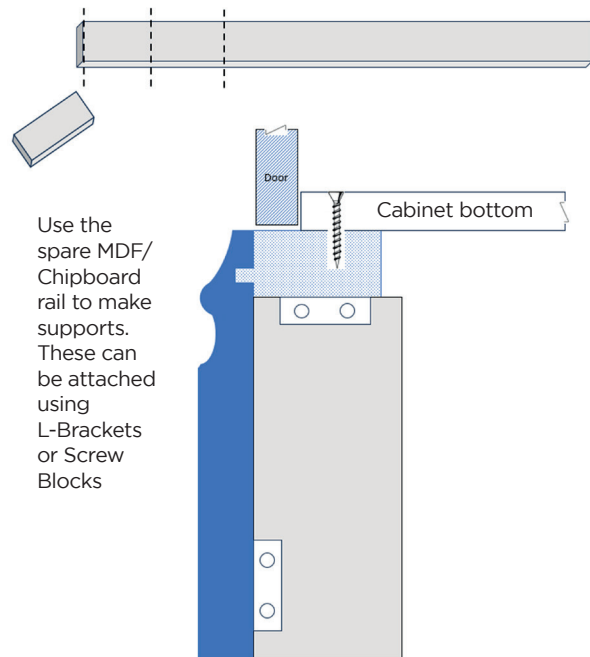

DECORATIVE SKIRTING PLINTH INSTALLATION

Decorative Plinth with Dishwasher Installation

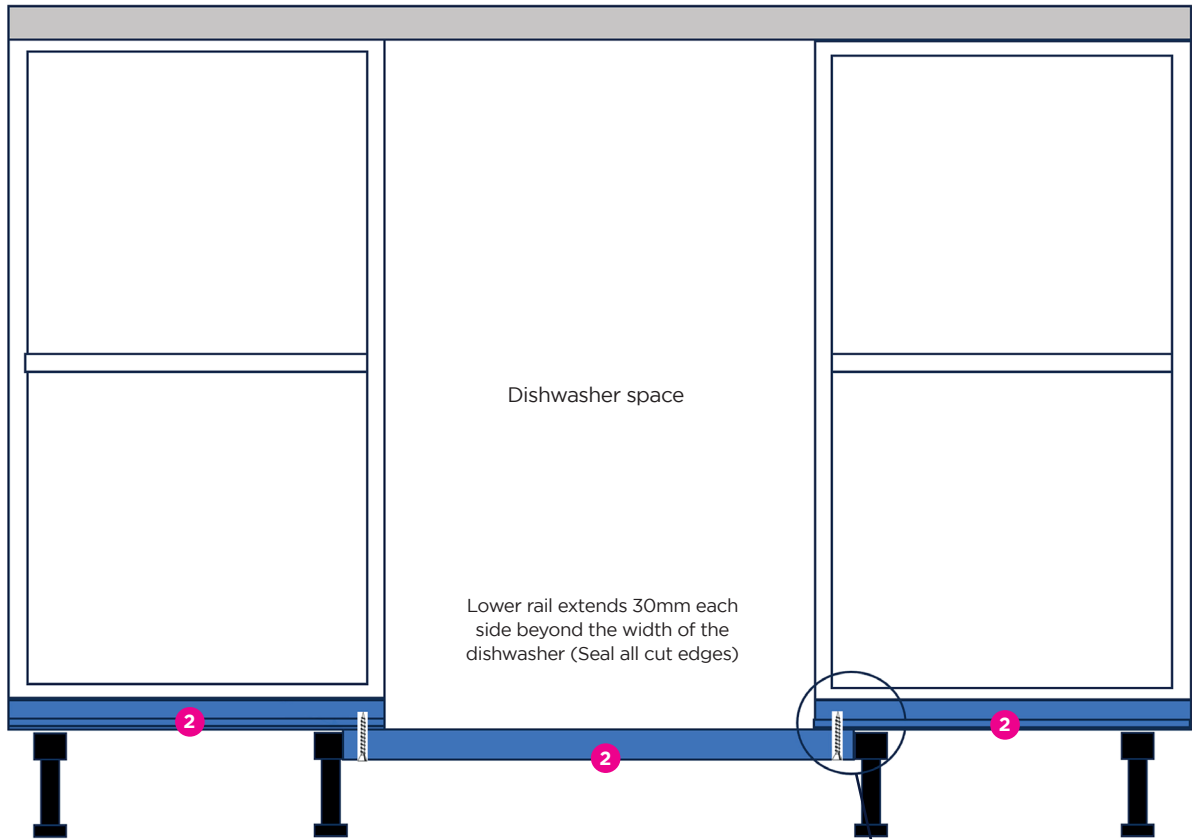

NB: There is no need to notch the plinth when you follow the guidelines

